

# **MID-RIVERS MACHINERY INC**

PO Box 186

Phone: 636.947.1513

St. Peters, MO 63376

[midriversmachinery@outlook.com](mailto:midriversmachinery@outlook.com)

## **ROTARY MACHINES**

### **Mid-Rivers Combination Rotary Machine means No More Hand Cranking!**

One foot valve allows the operator to use *both* hands while forming parts.

The advantages of using ROTARY MACHINES:

Features Hydraulic Powered top adjust down feed and Variable Force Controlled by foot switch for precise forming.

Safety: Machine stops and shafts open automatically when foot switch is released.

- Heavy Duty Depth Stop
- Hardened 1.25" Diameter Shafts
- Heavy Duty Needle Roller Bearings
- 115 Volt Electrical controls
- Reversible Drive (*Includes FWD/REV switch*).
- 0 - 50 FPM 1 hp A/C Inverter Motor.
- Variable Speed Control
- Maintains maximum Torque at lower speeds.

36 Month Limited Warranty on machine parts.  
Electrical Components warranted by their manufacturer.

## **MODELS**

### **Model HPR-1014**

Hydraulic Powered

115v 1hp single phase motor

Hardened 1.25" diameter shafts

Heavy duty needle roller bearings

Variable speed control maintains torque at lower speeds

0-50 FPM adjustable



**Proudly Made In The U.S.A.**

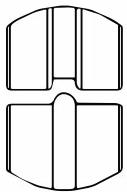

**1/4" BEAD**

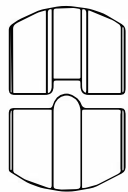

**5/16" BEAD**

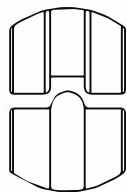

**3/8" BEAD**

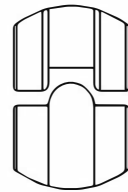

**1/2" BEAD**

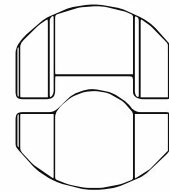

**1" BEAD**

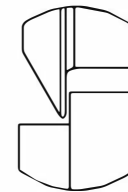

**3/8" FLANGE**

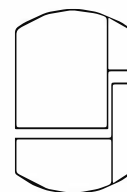

**1/2" FLANGE**

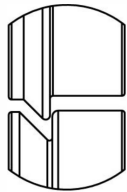

**GORE  
EDGE**

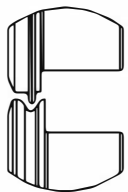

**ELBOW  
EDGE**

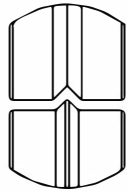

**V GROOVE**

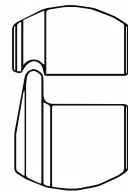

**TURNING**

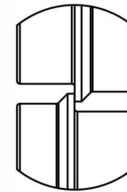

**SHEAR**

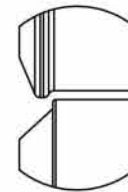

**OFFSET  
SWEDGE**

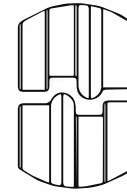

**OGEE**

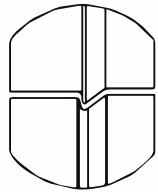

**FIRE DAMPER**

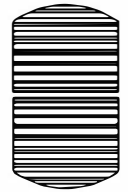

**2" WIDE  
CRIMP ROLL**

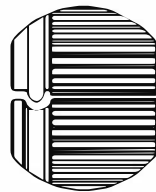

**5/16 front roll for  
crimp bead combo**

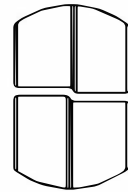

**1/16" STEP**

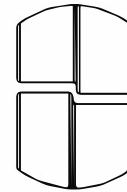

**1/8" STEP**

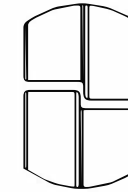

**3/16" STEP**

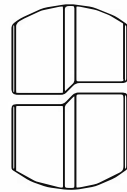

**45° STEP**



**FLAT HEM 3/8"  
STEP 1**

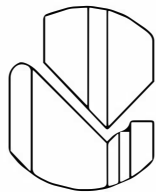

**FLAT HEM 1/4"  
STEP 1**

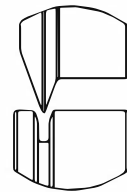

**FLAT HEM  
STEP 2**

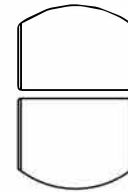

**FLAT HEM  
STEP 3**

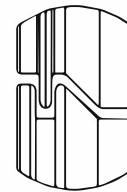

**SPIN COLLAR  
STEP 2**

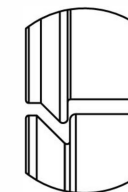

**SPIN COLLAR  
STEP 1**